

Type VK70 Vacuum Breaker



- G1/2" Screwed BSP
- Brass Body
- Up to 260°C
- Up to 16 Bar



Description

Vacuum Breaker-Designed for general purpose applications and used to break vacuum in a system when the system drops below atmospheric pressure. This device helps plant and process equipment against vacuum and at the same time allows condensate to drain effectively from the pipework and storage vessels.



Beschreibung

Vakuumbrecher - Entwickelt für allgemeine Anwendungen und zum Unterbrechen des Vakuums in einem System, wenn das System unter den atmosphärischen Druck fällt. Dieses Gerät hilft bei der Anlage und Verarbeitung von Geräten gegen Vakuum und ermöglicht gleichzeitig die effektive Ableitung von Kondensat aus den Rohrleitungen und Lagerbehältern.



Descripción

Rompe-vacío: diseñado para aplicaciones de uso general y utilizado para romper el vacío en un sistema cuando el sistema cae por debajo de la presión atmosférica. Este dispositivo ayuda a plantar y procesar el equipo contra el vacío y al mismo tiempo permite que el condensado se drene con eficacia desde las tuberías y los recipientes de almacenamiento.



Description

Disjoncteur sous vide - Conçu pour des applications générales et utilisé pour briser le vide dans un système lorsque le système descend en dessous de la pression atmosphérique. Cet appareil aide l'équipement de production et de traitement contre le vide et permet en même temps de purger efficacement les condensats de la tuyauterie et des cuves de stockage.

Description

Type VK70 Vacuum Breaker is a small vacuum breaker designed for general use for applications on condensing vapour or liquid systems, ideal for heat exchanger applications assisting in condensate removal. Unit should be installed in a vertical position. Brass construction with stainless steel internals and screwed 1/2" BSP PN16.



Options
Stainless Steel versions available
NPT screwed end connections

DIMENSIONS

Size	Type	A	B	C	Weight
1/2"	VK 70	55	34	39	0.4Kg

Technical - Valve

Max pressure	16 Bar
Max. temperature	0 - +260°C
Use on saturated Steam	11 bar / + 185°C

Materials - Valve

1	Cover	Brass CW 614N
2	Gasket	Stainless Steel 304
3	Valve	Stainless Steel 304
4	Valve Seat	Stainless Steel 304
5	Body	Brass CW 614N

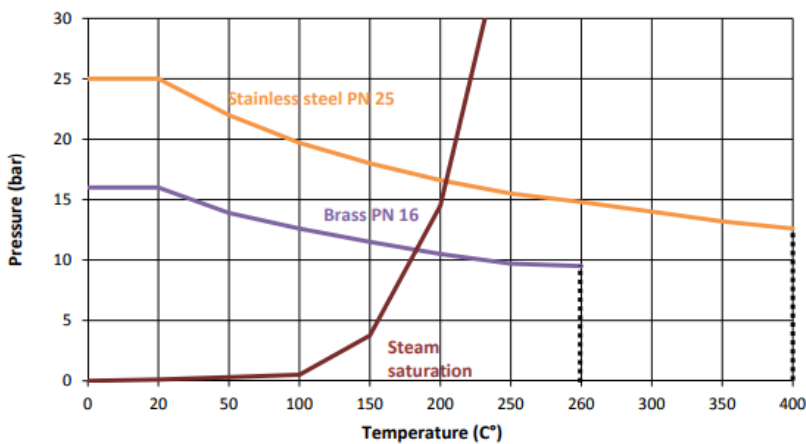
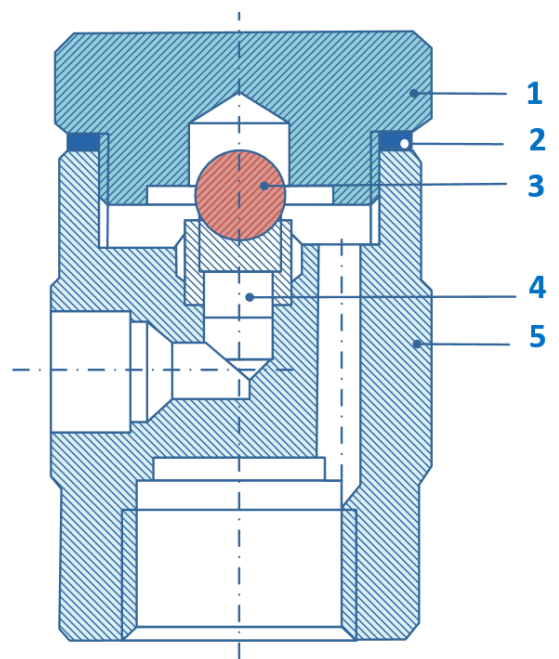
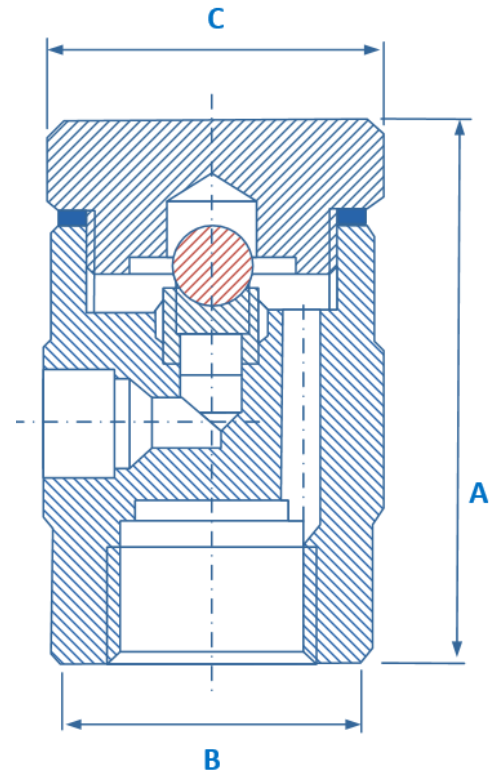

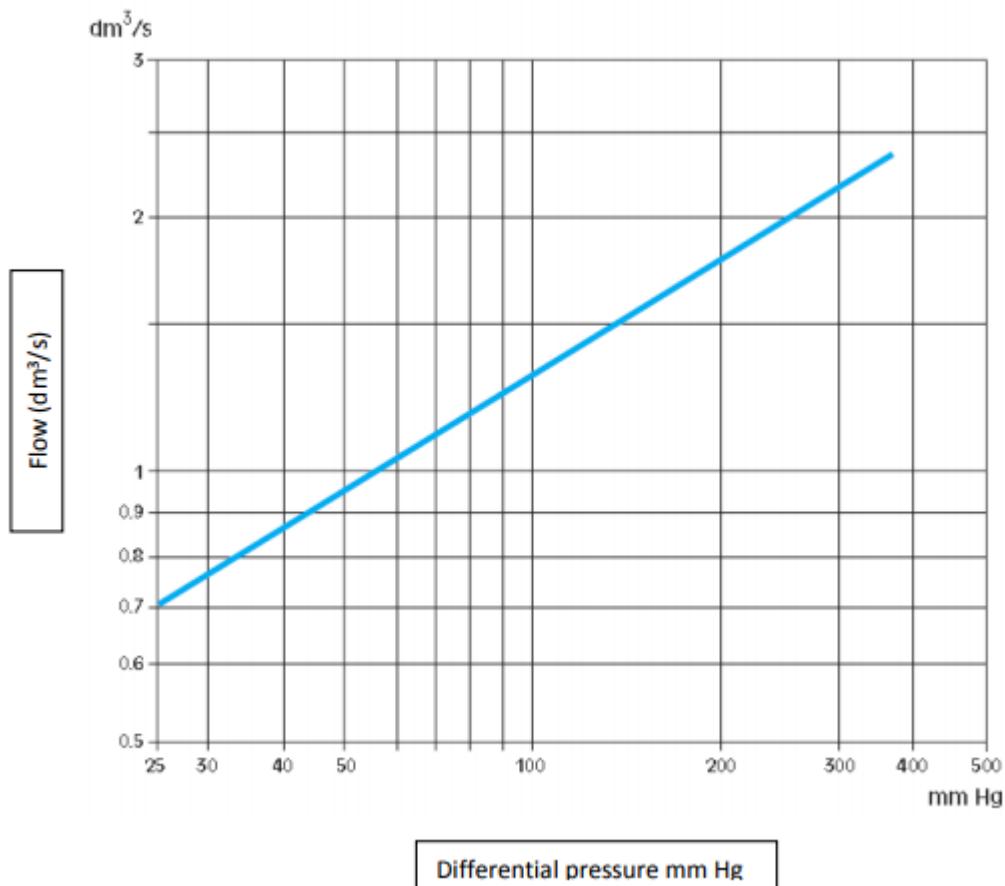
FLOWRATE (Dm3 /s)**Installation**

The vacuum breaker must be installed in a vertical position.

Mounting

1. Before any installation, split the flow of the upstream fluid
2. depressurise and drain the pipe or tank and allow to cool.
3. Install the ½" valve.
4. If the atmosphere is aggressive the admission of air can be linked to a safe area.

**Options**

Stainless Steel versions available
NPT screwed end connections