



## Description

The SV5217 is a miniature 1/4" ported Stainless Steel Normally Closed solenoid valve. Direct acting and operating from zero pressure up to 30 Bar (see pressure options). This valve is ideal for the on / off isolation of media such as air, water, gas, light oils, vacuum and slightly aggressive fluids. Opening and closing operating times are fast at between 10 and 20 milli seconds. The valve is compact in size and supplied with DIN connector. Options offered are various seal materials to suit compatibility with your media, options for preferred voltage supply and recommended orifice size that is most suitable for the pressure. The valve can be mounted in any position in areas of ambient temperature from -10°C up to 50°C. This valve is priced very economically and offers long life under rugged conditions.

- **Media: air, water, light oil, gas & vacuum.**
- Pressure range: 0 to 30 bar max
- Media temperature: 120°C max (see seals)
- Ambient temperature: -10° to +50°C max
- Media viscosity: 40 centistokes max
- Mounting: Coil any position
- Opening Closing time: 10-20 m Sec max
- Body: AISI303 Stainless steel
- Seal : NBR, EPDM, FKM,
- Weight including coil 280 grams

## Stainless Steel Solenoid Valve 1/4" Mini Direct Acting

- Economically Priced
- Size 1/4" (1/8" – SV5216)
- Normally Closed Function
- Media : Air, Water, Gas & Light Oil
- AISI303 St,St, Body,
- Various Seal Options
- Supplied with Plug Connector



### Description

Direct acting stainless steel solenoid valve. Suitable for pressures up to 30 bar. Used with media such as compressed air, water, light oils and gas. IP65 protected when connector fitted, High power coil optional. 1/4" ported and Normally Closed function.



### Beschreibung

Direktgesteuertes Magnetventil aus Edelstahl. Geeignet für Drücke bis 30 bar. Einsatz bei Medien wie Druckluft, Wasser, Leichtöle und Gas. IP65-geschützt bei montiertem Stecker, Hochleistungsspule optional. 1/4"-Anschluss und normal geschlossene Funktion.



### Descripción

Electroválvula de acero inoxidable de acción directa. Adecuado para presiones de hasta 30 bar. Se utiliza con medios como aire comprimido, agua, aceites ligeros y gas. Protegido IP65 cuando el conector está instalado, bobina de alta potencia opcional. Puerto de 1/4" y función normalmente cerrada.



### Description

Électrovanne en acier inoxydable à action directe. Convient pour des pressions jusqu'à 30 bars. Utilisé avec des fluides tels que l'air comprimé, l'eau, les huiles légères et le gaz. Protection IP65 lorsque le connecteur est installé, bobine haute puissance en option. Orifice 1/4" et fonction normalement fermée.

# SV5217

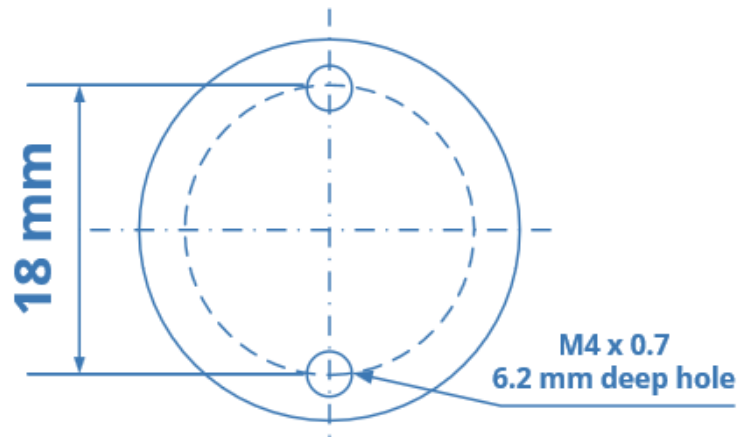
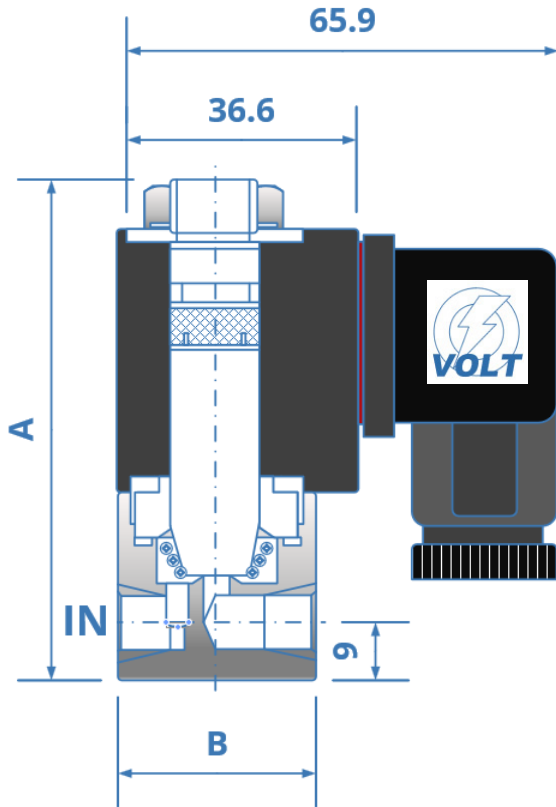

## Dimensions

Size	A	B	C	D
1/8"	76	30	15.2	17.8
1/4"	77	35	16	22

## Seal Material

NBR	50°C
EPDM	120°C
FKM	80°C

## Construction

Body	AISI303 Stainless Steel
Tube & Internal Parts	AISI303 Stainless Steel
Seals and gaskets	FKM (NBR & EPDM available)
Moulded Coil	Resin

## OPTIONS

IP65 Coil and Connector PG9 – DIN43650A  
 NPT and BSPT Thread  
 31400 High Power 14 – 20 Watt Coil  
 PTFE Seals

All information is sourced from our manufacturer's data and is intended for guidance only - Valves Online can accept no liability for changes, omissions or errors.

- Direct Acting
- 0 Bar needed to operate
- Normally Closed
- Good for Air and Liquids
- Supplied with plug
- Various Voltages

## Electrical Data

Voltage ( ±10%) Continuous duty 100%	Coil	Power Consumption		Insulation Class	Electrical Connections	Enclosure
		Inrush	Hold			
24-48-110-230 (50 or 60 Hz)	11630	26 VA	14 VA	H 155°C	3 Pins DIN 43650A DIN 40050 VDE 0110	IP65 with connector
12-24-48 (DC)		10 Watts				
24-48-110-230 (50 or 60 Hz)	31400	48 VA	26 VA			
12-24-48 (DC)		14 - 20 Watts				

## PRESSURE

Ø Port BSPT	Ø Orifice (mm)	Flow Kv Ltr/Min	Pressure Rating Bar ΔP				Seals	Max Media Temp. °C	
			Min	10 Watt Coil		14-20 Watt Coil			
				Max AC	Max DC	Max AC			Max DC
1/8"	1.6	1.43	0	20	15	30	20	NBR EPDM FKM	50 120 80
	2.4	3	0	10	9	20	15		
	3.2	4.71	0	7	6	15	10		
	4	6.14	0	5	4	10	8		
1/4"	1.6	1.43	0	20	15	30	20		
	2.4	3	0	10	9	20	15		
	3.2	4.71	0	7	6	15	10		
	4	6.14	0	5	4	10	8		
	5	7.1	0	4	3	6	4		

## Seal Material

NBR	50°C
EPDM	120°C
FKM	80°C

### OPTIONS

IP65 Coil and Connector PG9 – DIN43650A  
 NPT and BSPT Thread  
 31400 High Power 14 – 20 Watt Coil  
 PTFE Seals