





SKU: CV4675

-  PVC-U Wafer Swing Check Valve
-  PVC- U Wafer Válvula de retención oscilante
-  PVC- U Wafer Válvula de retención oscilante
-  PVC-U Wafer clapet antiretour du Balancement

Valves[™]
O N L I N E

- 63 – 250mm PVC Swing Check PN6/10
- 63 - 250mm PVC -RÜCKSCHLAG PN6 / 10
- 63 - 250mm PVC Cheque de Balance PN6 / 10
- 63 - 250mm PVC Balançoire Vérifier PN6 / 10

PVC WAFER SWING CHECK



Valve Supplied with

- Female Solvent Socket Flanges
- Flange bolts
- Wafer Check Valve

Description

Wafer Type Swing Check in PVC-U and O rings in EPDM (Viton on request)

Valve will fit between PN6 or PN10 flanges (see chart). This valve is ideal for use when space and weight savings are required and are an important factor. This valve is designed to fit between flanges without the need for additional gaskets. The eye bolt which is supplied with the valve is an aid to installation only.



Description

PVC-U Wafer swing type check valve, offering easy installation with low head loss. This valve should be installed horizontal or vertical (upwards only)



Beschreibung

PVC-U Wafer schwingen Rückschlagventil und bietet eine einfache Installation mit geringem Druckverlust . Dieses Ventil sollte installiert werden horizontal oder vertikal (nur nach oben)



Descripción

PVC- U Wafer girar la válvula de retención tipo , que ofrece una fácil instalación con baja pérdida de cabeza. Debe instalarse Esta válvula horizontal o vertical (hacia arriba solamente)







Description

PVC-U Wafer balancer vanne de contrôle de type , offrant une installation facile avec une faible perte de charge . Cette valve doit être installée horizontale ou verticale (vers le haut seulement)

Supplied as Shown



-  PVC-U Wafer Swing Check Valve
-  PVC- U Wafer Válvula de retención oscilante
-  PVC- U Wafer Válvula de retención oscilante
-  PVC-U Wafer clapet antiretour du Balancement

PVC-U Wafer Check Valve

- Requires little space in piping systems.
- Easy installation: wafer body slips between standard flanges. No gaskets required.
- Vertical and horizontal operation.
- Available with EPDM or Viton® O-Rings.
- Excellent flow characteristics.
- Sizes from 75 mm to 225 mm (2½" - 8").
- Available Standards: ISO/DIN, ANSI/ASTM.

Do not install the valve at a distance lower than 5 x D of the pump out.
Install with pipe and flange DIN PN10.

- Minimum return pressure: 0,2 bar (3 psi).

Working pressure at 20°C (73°F) water temperature:

- D75 - D140 (2½" - 5"): PN 10(150 psi)
- D160 - D225 (6" - 8"): PN 6 (90 psi)

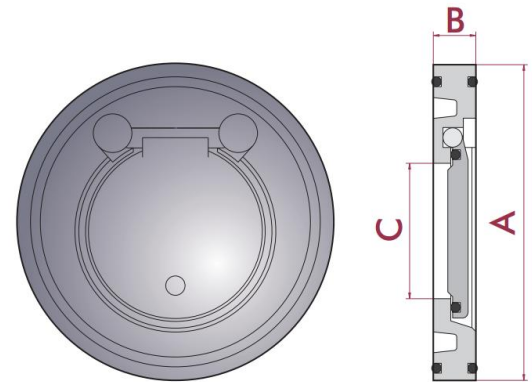



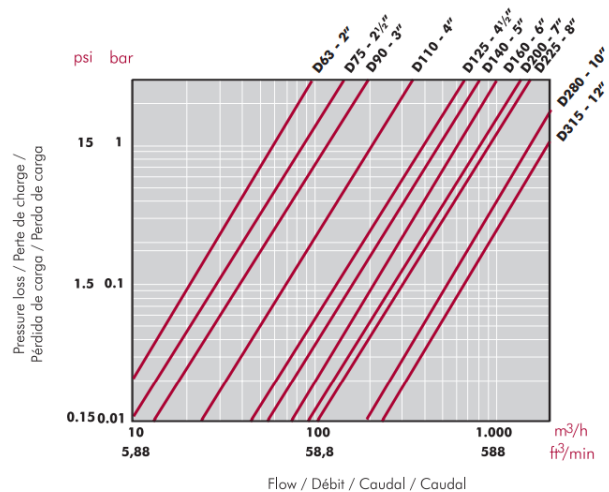
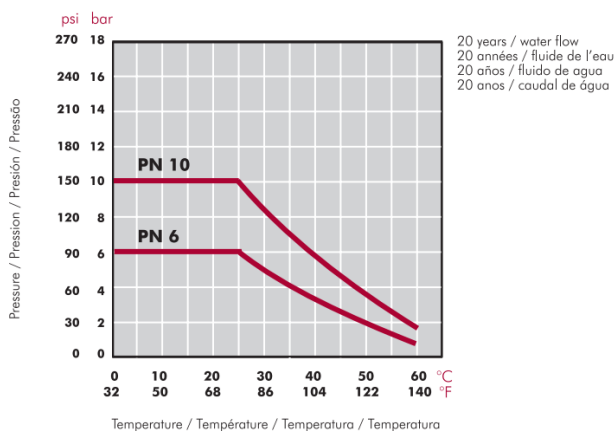

DIMENSIONS					
D	DN	PN	A	B	C
63	50	10	109	20	34
75	65	10	129	20	40
90	80	10	144	20	52
110	100	10	164	22	70
125	110	10	170	25	83
140	125	6	195	23	92
160	150	6	220	25	112
200	175	6	247	28	139
225	200	6	275	35	150
280	250	6	330	40	189
315	300	6	380	45	226

Pressure/ Temperature Graph



FLOW

-  PVC-U Wafer Swing Check Valve
-  PVC- U Wafer Válvula de retención oscilante
-  PVC- U Wafer Válvula de retención oscilante
-  PVC-U Wafer clapet antiretour du Balancement

PVC-U Wafer Check Valve

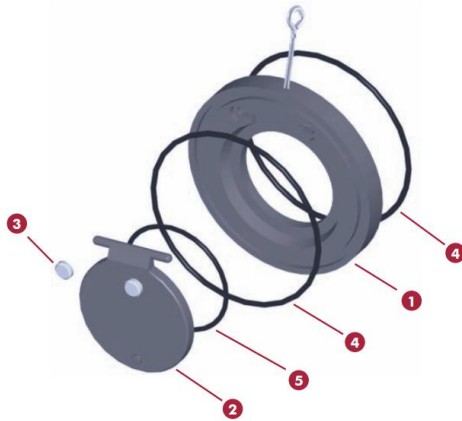

Description		
FIG.	Part	Material
1	Body	PVC-U
2	Flap	PVC-U
3	Cap	PP
4	Body O Ring	EPDM/Viton
5	Flap O Ring	EPDM/Viton

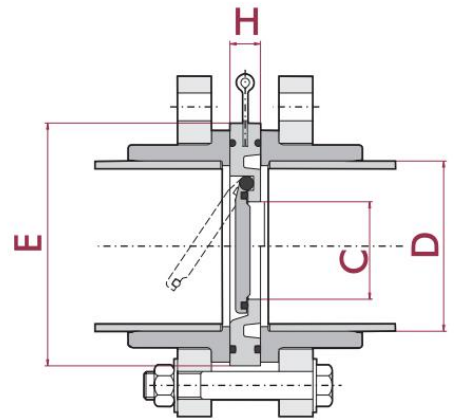

Swing Check Valve with Mounting Kit

Female Solvent Socket Metric Flanges supplied with 2 flanges wafer check valve and flange bolts as one item.

DIMENSIONS					
D	DN	PN	A	B	C
63	50	10	109	20	34
75	65	10	129	20	40
90	80	10	144	20	52
110	100	10	164	22	70
125	110	10	170	25	83
140	125	6	195	23	92
160	150	6	220	25	112
200	175	6	247	28	139
225	200	6	275	35	150
280	250	6	330	40	189
315	300	6	380	45	226