



Description

Both Slim and Deep case gauges are used as standards within the HVAC and Industrial industries. Specifically designed for the UK's heating / ventilation, mechanical services and air conditioning markets. This gauge can be fitted with various U or pig tail syphon's for hot applications.

- Highly viscous
- High temperature (over 60°C)
- Likely to solidify/crystallize
- Corrosive to copper or tin alloys

Also suitable for gases (excluding oxygen or acetylene) up to 25 bar maximum.

Both gauges have dual scale in PSI and Bar.

Blow out bung / disc fitted to both gauges.

Industrial Pressure Gauge HVAC

- Slim or Deep Case
- 100mm Diameter
- 1.6% - 1% Accuracy
- Bottom Mounted
- -20°C to + 60°C
- Dual scale in PSI and Bar



Description

For the measurement of fluids. Supplied in either slim or a deep 100mm case, in black enamelled steel with a stainless steel bezel. This heavy duty HVAC pressure gauge has a temperature Range -20°C to 60°C. The gauges are offered with a bottom or centre back connection and the pressure element is a sealed bourdon tube C type. Typical industries are for Pneumatics, Air Compressors, HVAC and the Water Industry.



Beschreibung

Für die Messung von Flüssigkeiten. In schlankem oder tiefem 100-mm-Gehäuse, in schwarz emailliertem Stahl mit Edelstahl-lunette. Dieses Hochleistungs-Druckmessgerät hat einen Temperaturbereich von -20°C bis 60°C. Die Messgeräte werden mit einer Boden- oder Mittelrückverbindung angeboten und das Druckelement ist ein abgedichteter Rohrfeder-C-Typ. Typische Industrien sind Pneumatik, Luftkompressoren, HVAC und die Wasserindustrie.



Descripción

Para la medición de fluidos. Se suministra en una caja delgada o profunda de 100 mm, en acero esmaltado negro con un bisel de acero inoxidable. Este manómetro HVAC de alta resistencia tiene un rango de temperatura de -20°C a 60°C. Los medidores se ofrecen con una conexión inferior o central trasera y el elemento de presión es un tipo sellado de tubo de Bourdon. Las industrias típicas son para Neumática, Compresores de aire, HVAC y la Industria del agua.



Description

Pour la mesure des fluides. Livré dans un boîtier mince ou profond de 100 mm, en acier émaillé noir avec une lunette en acier inoxydable. Ce manomètre HVAC pour usage intensif a une plage de température de -20°C à 60°C. Les jauges sont proposées avec une connexion au fond ou au centre et l'élément de pression est un tube de type bourdon scellé. Les industries typiques sont pour la pneumatique, les compresseurs d'air, le HVAC et l'industrie de l'eau..

Bottom Mount (BM)

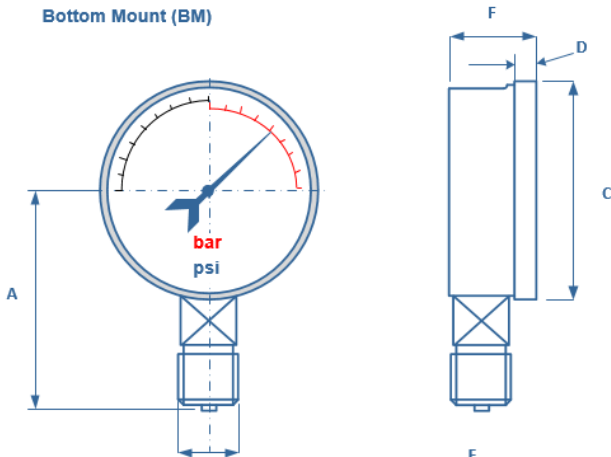

Centre Back Mount (CBM)

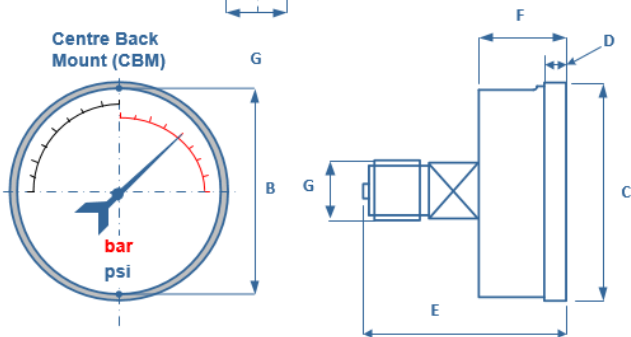

Attribute - Slim Case	Value
Nominal Size	100mm
Accuracy	100mm - 1.6%,
Series	PG2000
Scales	as above
Ranges	-30 HG Vacuum to 0/400 PSI (28Bar) Pressure
Mounting Options	Bottom, Centre Back and Surface Mounting
Operating Temperatures	Ambient: -20/+60°C Medium: +60°C maximum
Ingress Protection	IP 40 as per EN 60529
Case	Enameled Steel - Slim Black
Window	100mm Acrylic - Crystal clear, push fit .
Pressure Element	CU Alloy - Sealed Bourdon tube C-Type
Joints	Soldered with tin alloy
Movement	High Precision Brass
Process Connection Block	See Product Selector
Pointer	Aluminium - Black
Dial	Aluminium - White

Attribute - Deep Case	Value
Nominal Size	100mm
Accuracy	+/- 1.0% FSD
Scales	BAR Outer (Black) & PSI Inner (Red) - Pressure BAR Outer (Black) & "HG Inner (Red) - Vacuum BAR Outer (Black) & "HG+PSI Inner (Red) - Compound
Ranges	-1/0 BAR Vacuum to 0/70 BAR Pressure
Mounting Options	Bottom - Direct Mounting (standard) Bottom - Surface Mounting with Rear 3 Hole Flange
Operating Temperature	Ambient: -20/+60°C Medium: +60°C maximum
Ingress Protection	IP 40 as per EN 60529
Case	Enameled Steel - Black Deep Case
Bezel	304 Stainless Steel
Window	Acrylic - Crystal clear
Pressure Element	CU Alloy - Sealed Bourdon tube C-Type
Joints	Soldered with tin alloy
Movement	High Precision Brass
Process Connection & Block	Brass - 3/8" BSP (parallel) male (standard) Brass - 22mm Square block
Rear Blow-Out	30mm Black rubber
Pointer	Aluminium - Black
Dial	Aluminium - White

Dimensions in mm

Size	A	B	C	D	E	F	G	Weight kg
100 Slim Case	80	90	100	18	70	36	3/8"	307g
100 Deep Case	80	90	100	18	70	47	3/8", 1/2"	449g