

CV4307

BRASS SINGLE CHECK VALVE CR

COMPRESSION ENDS,

HEAVY PATTERN



Economical, maintenance free valve having the following key features:

- **Single check valve CR**
- **Brass body**
- **Compression ends**
- **Available in sizes 15mm, 22mm and 28mm**

DETAILS

Our brass bodied single check valve CR is suitable for general plumbing, heating systems and domestic applications.

Available with compression ends in sizes 15mm, 22mm and 28mm.

With a working temperature range of -10°C to 100°C.

PN16 pressure rating with an opening pressure of 0.02 Bar.

An economical, maintenance free valve.

BRASS SINGLE CHECK VALVE CR

COMPRESSION ENDS, HEAVY PATTERN

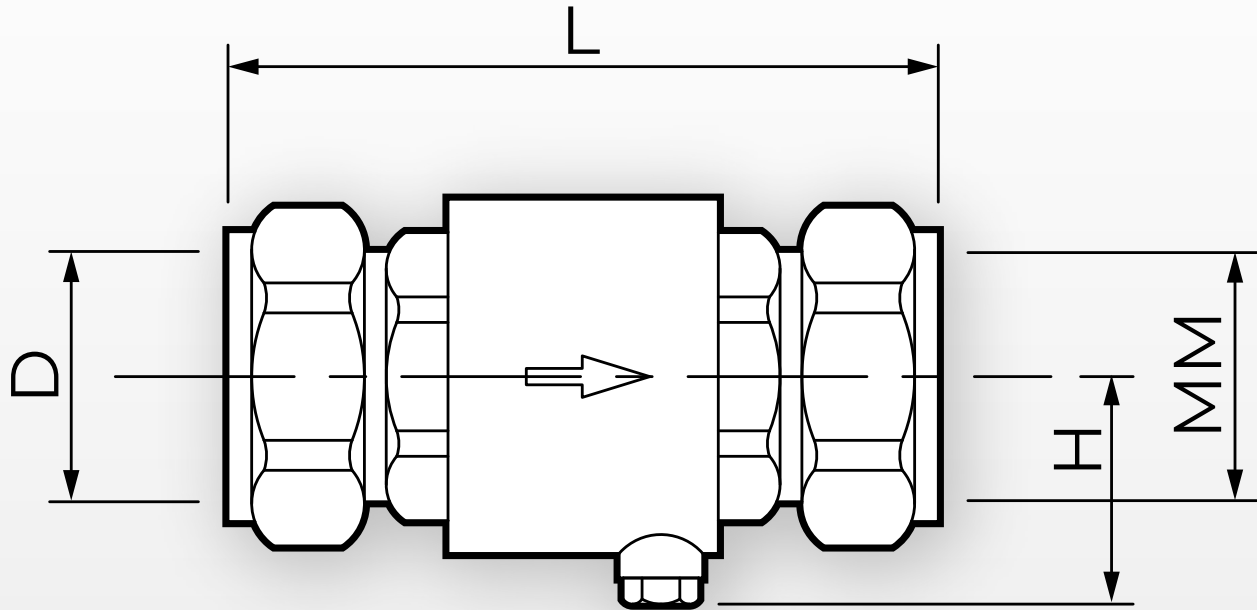

TABLE 1: DIMENSIONS IN MM

MM	L	H	D	Kg	SKU
15	52	22	15.2	0.17	CV4307-105300
22	63	25	22.2	0.26	CV4307-105301
28	74	29	28.3	0.39	CV4307-105302

Note: face-to-face approximation taken from non-installed stock and is subject to change once compressed.

TABLE 2: MATERIALS

Item	Material
Body	CW617N brass
Nut	CW617N brass
Olive	CW614 brass
Disc	POM
Washers	NBR
Spring	Stainless steel

TABLE 3: RATINGS

Pressure/Temperature	Specification
Pressure	PN16
Opening pressure	0.02 Bar
Temperature	-10°C to 100°C