





SKU: CV4664

-  VOLT Ball Check Valve Screwed BSPP
-  VOLT Kugelrückschlagventil Screwed BSPP
-  VOLT Bola de la válvula de retención Screwed BSPP
-  VOLT Bal Consultez Screwed Valve BSPP

Valves[™]
O N L I N E

- 1" - 3" Ball Check Valve Cast Iron Screwed
- 1" - 3" Kugelrückschlagventil Gusseisen Screwed
- 1" - 3" Bola de la válvula de retención de hierro fundido atornillado
- 1" - 3" Fer vanne à billes Cast Screwed



- **Economical**
- **Low Cracking Pressure**
- **Full Bore**
- **High Flow Rates**
- **Easy to Maintain**

Description

Ball Check Valve, Cast Iron Body & Bonnet , NBR Seat, Phenolic Resin Ball 1" to 1 1/2", NBR Coated Aluminium Ball 2" to 3", Screwed BSPP, PN10 Rated, Temperature -10°C to 70°C.

Applications

Pumping stations for clean, sewage water and loaded or viscous fluids.

Screwed Ball Check Valve



Description

A screwed BSPP ball check valve that offers low pressure drop, low cracking pressure and easily is installed. Cast Iron epoxy painted body, easy to maintain and can be installed in horizontal or vertical positions. Temperature -10°C to 70°C
Pressure range PN10



Beschreibung

A verschraubt BSPP Kugelrückschlagventil , die einen geringen Druckabfall , niedrige Öffnungsdruck bietet und einfach installiert . Cast Iron Epoxydharzlackierung Körper , einfach zu warten und können in horizontaler oder vertikaler Position installiert werden. Temperatur -10 ° C bis 70 ° C
Druckbereich PN10







Descripción

Se instala una válvula de retención de bola BSPP atornillado que ofrece una baja caída de presión, baja presión de agrietamiento y fácilmente. Cast cuerpo pintado epoxi de hierro , fácil de mantener y se puede instalar en posición horizontal o vertical . Temperatura -10°C a 70°C
Rango de presión PN10



Description

Un BSPP clapet à bille vissé qui offre une faible chute de pression , la pression de craquage faible et facilement est installé . Cast époxy Fer corps peint , facile à entretenir et peut être installé dans des positions horizontales ou verticales . Température -10 ° C à 70 ° C
Plage de pression PN10.

-  VOLT Ball Check Valve Screwed BSPP
-  VOLT Kugelrückschlagventil Screwed BSPP
-  VOLT Bola de la válvula de retención Screwed BSPP
-  VOLT Bal Consultez Screwed Valve BSPP

Screwed Ball Check Valve

- Economical
- Low Cracking Pressure
- -10°C to 70°C, PN 10 Rated
- Full Bore, High Flow Rates
- Easy to Maintain

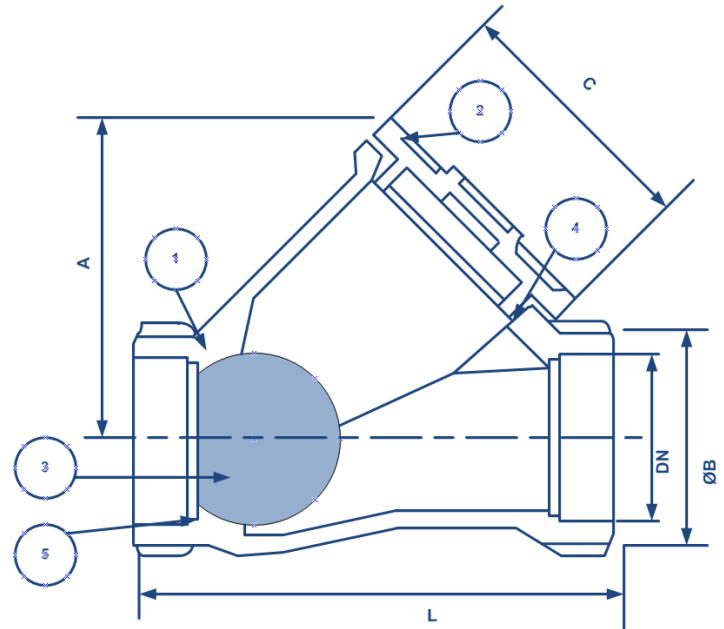
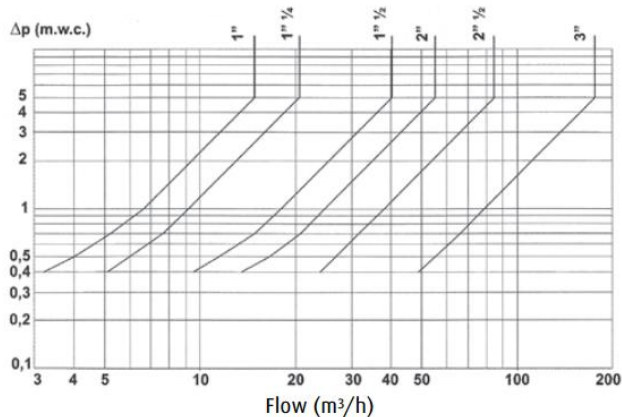

Material List

Item	Description	Material
1	Body	Cast Iron GG-25 (EN-GJL-250)
2	Bonnet	Cast Iron GG-25 (EN-GJL-250)
3	Ball	1" - 1 1/2" Phenolic Resin
4		2" - 3" NBR Coated Aluminium
5	Seal Gasket	Elastomer /NBR
6	Bonnet Gasket	Elastomer /NBR
7	Bolting	316 CF8M

Dimensions

DN	Size	A	B	C	L	Kv	Weight (kg)	Cracking
25	1"	85	57	110	141	21	0.69	24
32	1 1/4"	85	57	110	141	29	0.85	14.6
40	1 1/2"	90	64	120	150	57	1.2	16
50	2"	115	77	140	175	78	1.8	21
65	2 1/2"	135	95	155	214	120	3.5	22.3
80	3"	160	108	185	248	250	5	67